

SRFS TELEINFRA

0.8mm Male to 1.0mm Male Adaptor

Get connected with us:

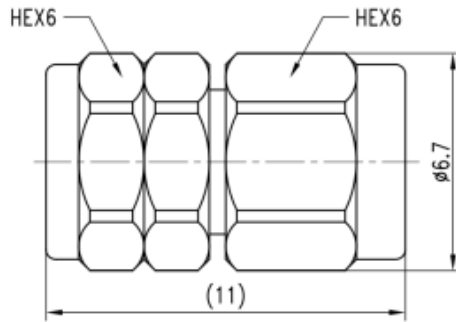

Electrical & Mechanical Specifications	
Impedance	50 Ohm
Frequency Range	DC-110 GHz
VSWR	1.35 max
Operating Temp	-55°C to +85°C
Connector Body	Passivated stainless steel
Center Contact	Gold plated beryllium copper
Insulator	PEIs

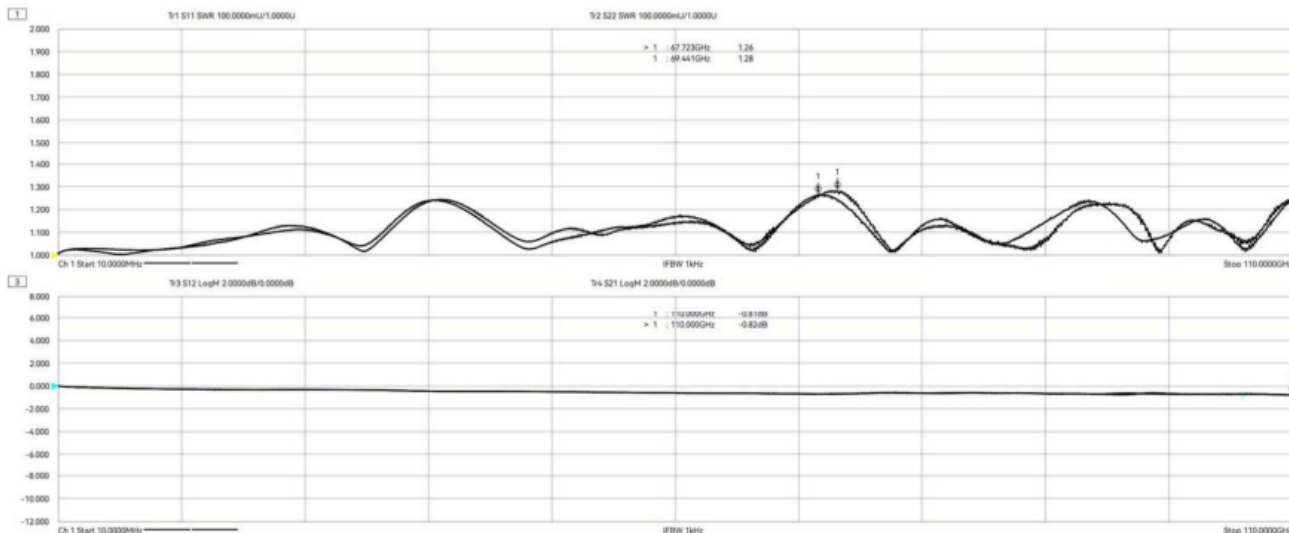

	Sweep Type	Start Freq(GHz)	Stop Freq(GHz)	Sweep Points	IF Bandwidth(Hz)	Sweep Time(s)	Port 1,2Power(dBm)
Ch 1	LIN Freq	0.01	110	1601	1000	1.57903	-5,-5

Add: plot no 10 shiv vihar a block Najafgarh Sahibi river road Vikasnagar Uttam nagar new delhi-110059

+91 84354 74330 info@srfsteleinfra.in, sales@srfsteleinfra.com

www.srfsteleinfra.in, www.srfsteleinfra.com

SRFS Teleinfra | All specifications are subject to change.
SRFS reserves the right to make such changes as required. Unless otherwise stated, all specifications are nominal.
It may be necessary to make modifications to the part and/or the documentation of the part to implement improvements.
See www.srfsteleinfra.in for the most current information. Revised: 19 Jan 2023

