

# SRFS TELEINFRA

Get connected with us:

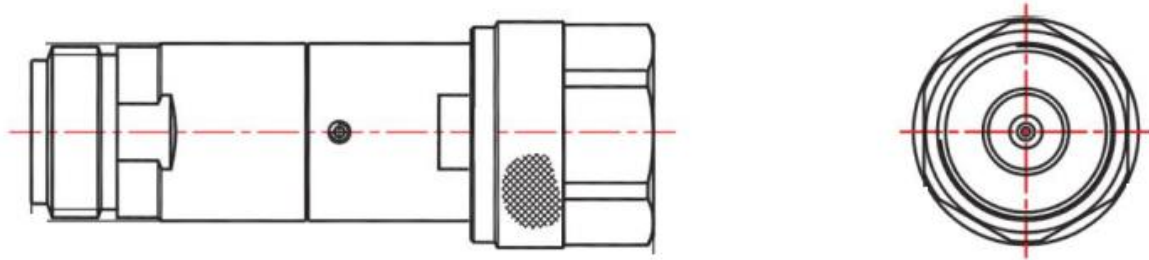

## 10dB Fixed Attenuator Model No.- SRFS-FAT-10



Technical & Mechanical Specifications	
Frequency	DC-18 GHz
Impedance	50 ohm
VSWR	1.35 max
Input Avg Power	5W@ 25°C
Peak Power	500W
Voltage Withstand	Bidirectional, N female to N male
Attenuation	10 dB
Accuracy(dB)	±0.7
Connector Body	Ternary alloy plated brass
Heat Sink	N/A
Center Contact	Gold plated beryllium copper/brass
Operating Temperature	-55°C to 100°C
Storage Temperature	-55°C to 125°C
RoHS Compliant	yes

Add: plot no 10 shiv vihar a block Najafgarh Sahibi river road Vikas Nagar Uttam nagar new delhi-110059

+91 7838349349, +91 8076749052 info@srfsteleinfra.in, sales@srfsteleinfra.in, srfsteleinfra@gmail.com

www.srfsteleinfra.in, www.srfsteleinfra.com

SRFS Teleinfra | All specifications are subject to change.  
SRFS reserves the right to make such changes as required. Unless otherwise stated, all specifications are nominal.  
It may be necessary to make modifications to the part and/or the documentation of the part to implement improvements.  
See www.srfsteleinfra.in for the most current information. Revised: 19 Jan 2023

