

Features:

1. Frequency covers 698-960,1710-2170,2300-2700 3300-4000 MHz
2. Low PIM
3. Pole or wall mounting
4. Suitable for indoor and outdoor application

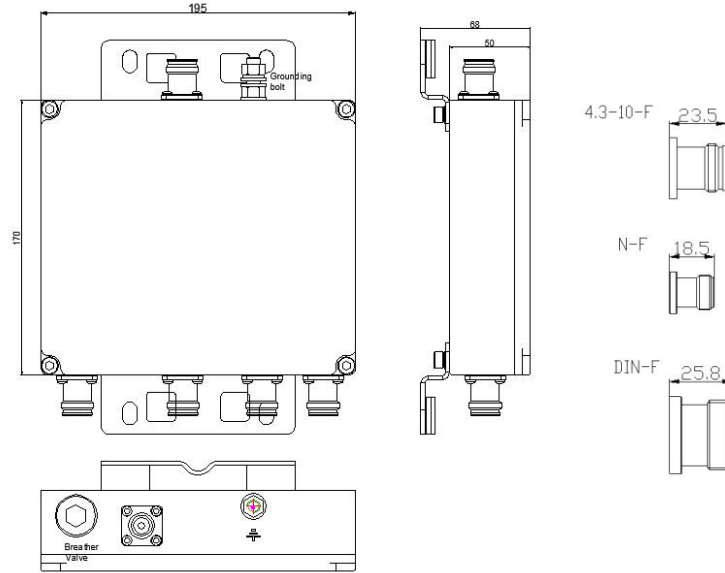

Electrical & Mechanical Specifications				
Freq (MHz)	698-960	1710-2170	2300-2700	3300-4000
Insertion Loss(dB)	0.4±0.1			
Isolation(dB)	>50			
Return Loss(dB)	≥19			
VSWR (dB)	≤ 1.25			
PIM (dBm)	≤ -153dBc@ 2 x 43dBm			
Maximum Input (W)	500 W			
Operating temperature (°C)	-40°C ~ +80°C			
Relative humidity (°C)	Up to 95 %			
Impedance	50 Ω			
Lightning Protection	DC Ground			
Connector Type	N Female/4.3-10 Female/DIN Female			
Ingress protection	Indoor/outdoor			
Color	Grey (M L440c)			
ROHS Compliance	Yes			
Mounting	Wall Mount or Pole Mount			