

SRFS TELEINFRA

Get connected with us:

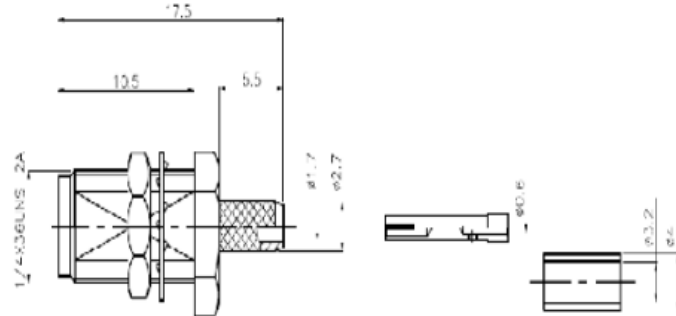

SMA Female Bulkhead Crimp Connector For RG316/RG174/RG188/LMR100 Cable



ELECTRICAL & MECHANICAL SPECIFICATIONS		
Frequency Range	DC-12.4 GHz	
VSWR (max)	≤1.20@DC-3GHz	
Dielectric Withstanding Voltage	1000Vrms, 50 Hz at sea level	
Working Voltage	335V RMS, 50Hz, at sea level	
Characteristic Impedence	50 Ω	
Contact Resistance	Center Contact ≤3mΩ Outer Contact ≤2.5mΩ	
Dielectirc Resistance	≥5000MΩ	
Durability	Mating Cycles ≥500	
Material & Plating		
	Material	Plating
Body	Brass	Au
Insulator	PTFE(Teflon)	-
Center conductor	Phosphor bronze	Au
Fastening Nut	Brass	Au
Washer	Brass	Au
Ferrule	Annealed Copper	Ni
Environmental		
Temperature Range	-40°C~+85°C	
Waterproof Rate	IP 67	
RoHS	Compliant Yes	

Add: plot no 10 shiv vihar a block Najafgarh Sahibi river road Vikasnagar Uttam nagar new delhi-110059
 +91 7838349349, +91 8076749052 info@srfsteleinfra.in, info@srfsteleinfra.in, srfsteleinfra@gmail.com
 www.srfsteleinfra.in, www.srfsteleinfra.com

SRFS Teleinfra | All specifications are subject to change.
 SRFS reserves the right to make such changes as required. Unless otherwise stated, all specifications are nominal.
 It may be necessary to make modifications to the part and/or the documentation of the part to implement improvements.
 See www.srfsteleinfra.in for the most current information. Revised: 19 Jan 2023

