

SRFS TELEINFRA

N Male to N Female Right Angle Adaptor

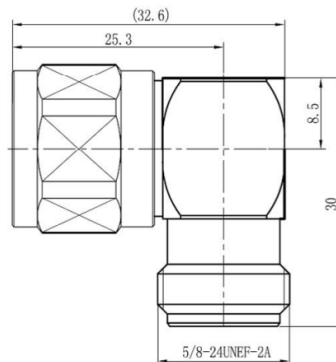

Electrical & Mechanical Specification		
Characteristic Impedance	50Ω	
Frequency Range	0-8GHz	
VSWR	820MHz ~ 2635MHz ≤ 1.12; 2635MHz ~ 3000MHz ≤	
IL	≤0.05 dB	
Intermodulation@2-tonex20w	≤-163dBc @ 2*20W	
Dielectric Withstanding Voltage	≥2000V, AC, 1Min	
Contact resistance	outer contact ≤1.0mΩ center contact ≤0.25mΩ	
Dielectric Resistance	≥5000MΩ	
Retention	≥0.56N	
Durability	Mating cycles ≥500	
Environmental Specification		
Temperature Range	-40°C ~ +85°C	
Watertightness	IP67	
ROHS	Yes	
Material & Plating		
Body	Brass	Tri-Alloy ≥ 3μm
Center conductor	Brass/phosphor bronze	Ag ≥ 3μm
Outer contact plating	Silver	
Inner contact plating	Silver	
Insulator	PTFE	
Sealing ring	Silicone rubber	
Other Metal parts	Brass	Ni ≥ 2.5μm



Add: plot no 10 shiv vihar a block Najafgarh Sahibi river road Vikasnagar Uttam nagar new delhi-110059
 +91-9027232570, +91-8800726650, +91 8076749052 info@srfsteleinfra.in, info@srfsteleinfra.com, srfsteleinfra@gmail.com
 www.srfsteleinfra.in, www.srfsteleinfra.com

SRFS Teleinfra | All specifications are subject to change.
 SRFS reserves the right to make such changes as required. Unless otherwise stated, all specifications are nominal.
 It may be necessary to make modifications to the part and/or the documentation of the part to implement improvements.
 See www.srfsteleinfra.in for the most current information. Revised: 19 Jan 2023

