

SRFS TELEINFRA

N-M/F DC Block

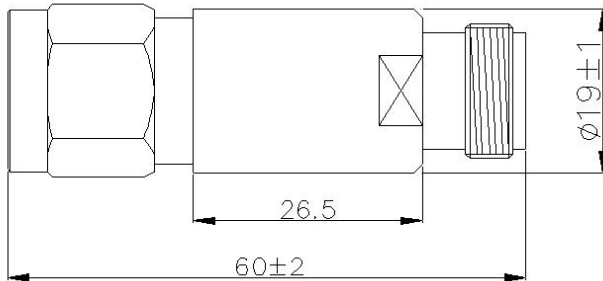

ELECTRICAL & MECHANICAL SPECIFICATIONS	
Item	DC Block
Model	SRFS- DCSTOP-50-6000
Frequency	50-6000MHz
VSWR	≤ 1.15
PIM3	≤-153dBc@2×43dBm
Impedance	50(Ω)
Power	200 (W)
Connector	N-Male/Female
Blocking Voltage	200V
Weight	150 (g)
Operating temperature(°C)	-55~+125